

IMPORTANT LIFTING KIT ASSEMBLY

Assembly and fitment of the Lifting Kit to a RedGum Extra or RedGum Deluxe model log splitter is very similar to the assembly of a Redgum Deluxe Lifter.

The main difference is that the brackets on a Deluxe Lifter are already fitted to the unit, whereas the Lifting kit requires the brackets to be fitted

NOTE:

To ensure the overall stability and safe function of the machine you are required to make the following modifications to the unit:

- 1) Remove the Rear Support Leg, keeping aside the hex bolt, flat washers (2) and hex lock nut

- 2) Remove the safety pin, which releases the unit into the vertical position, and replace with the hex bolt, flat washers (2) and hex lock nut from the rear support leg to fix the log splitter in the horizontal position

- 3) See attached full fitting instructions for the lifting kit

LIFTING KIT FITTMENT INSTRUCTIONS

STEP 1 – ATTACH THE CONNECTING FRAME & SUPPORT LEG FIXED BASE TO THE BEAM

- 1. Attach the Lifting Table Connecting Plate (#126) to the Connecting Frame (#78) using the Hex Bolt M8 (#127) Washer M8 (#128) and Hex Nut M8 (#129)**
- 2. Attach the Connecting Frame (#78) and Lifting Table Fixed Plate x 2 (#123) to the beam, and fasten together with the Hex Bolt M8 (#127) Washer M8 (#128) and Hex Nut M8 (#129)**
- 3. Attach the Support Leg Fixed Base (#121) to the Rear Support Leg (#34) using the Hitch Pin (#33) and R pin (#77)**
- 4. Attach the Support Leg Fixed Base (#121) and Fixed Plate x 2 (#122) to the beam, and fasten together with the Hex Bolt M8 (#127) Washer M8 (#128) and Hex Nut M8 (#129)**

STEP 2 – ATTACH THE LIFTING CYLINDER AND LIFTING TABLE

- 5. Attach the Lift Cylinder (#70) Piston Connector (#72) and Lift Arm (#81) which come assembled in the crate, and the Lifting Table (#82) to the Connecting Frame. Secure using Shaft (#76) Flat Washer x 2 (#75) and Cotter Pin x 2 (#74)**

*** Ensure the direction of the lift arm (#81) is correct as per the drawing**

STEP 3 – ATTACH THE LIFT CYLINDER CONTROL VALVE AND HYDRAULIC HOSE

- 6. Attach the Control Valve (#6) and Connecting Frame (#28) which come assembled, to the oil tank and secure with the Valve Frame Mounting Fixed Plate (#124) Pull Rod x 2 (#125) Hex Nut x 2 (#129) and Washer x 2 (#128)**
- 7. Connect the Hydraulic Hose to the Gear Pump and Lift Cylinder**

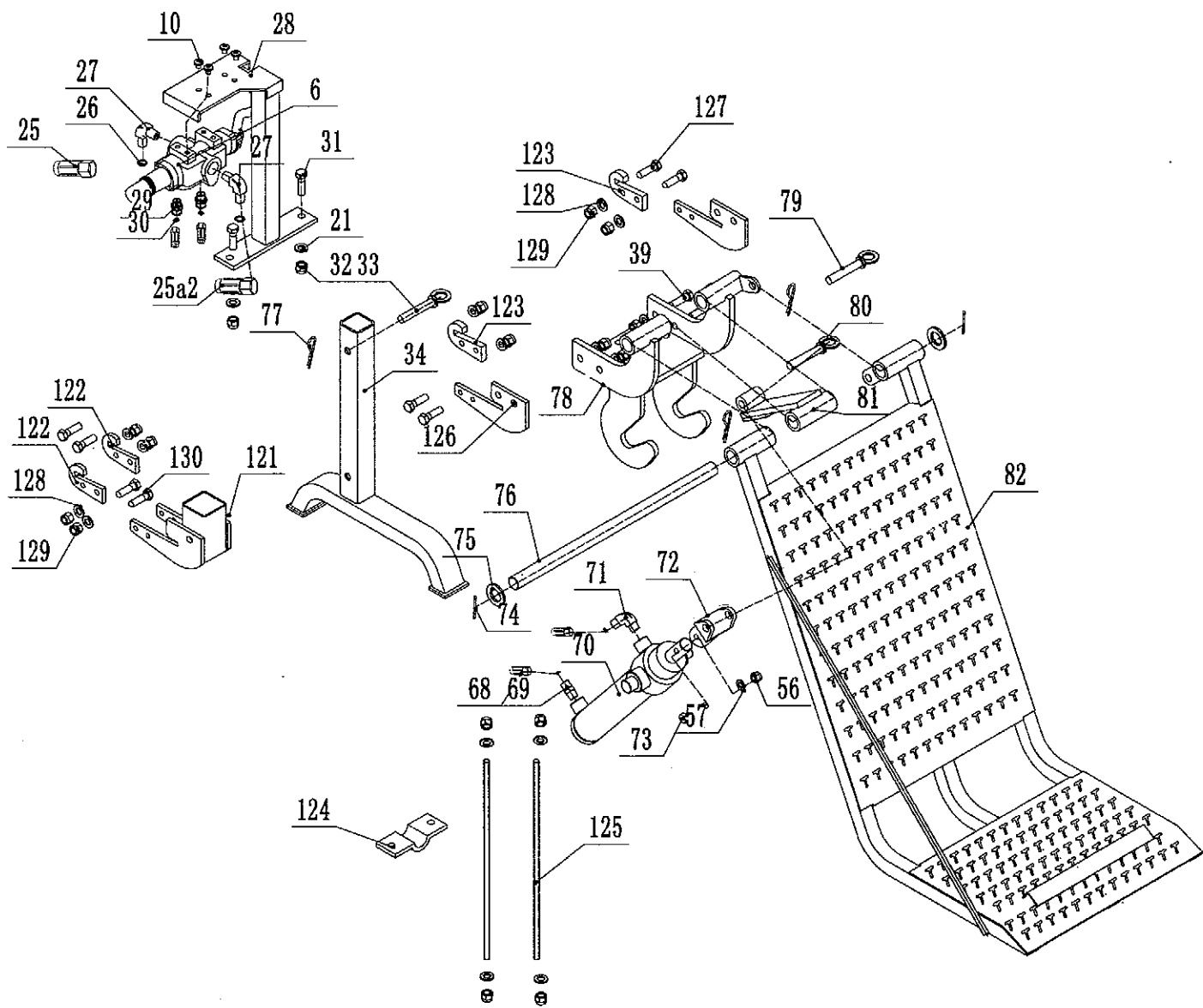

LIFT TABLE KIT COMPONENTS

**CONNECTING
FRAME**

**FIXED PLATES &
CONNECTING PLATES**

LIFTING TABLE

SHAFT

**REAR SUPPORT
LEG**

**VALVE FRAME
MOUNTING PLATE
& PULL RODS**

**LIFT CYLINDER
W/LIFT ARM**

**HITCH PIN &
PIN SHAFT**

**CONTROL VALVE,
CONNECTING FRAME &
4 x HYDRAULIC HOSES**

