

REDGUM MAX + LIFTER 390

POWERED by
HONDA™



Owner's Manual

REDGUM LOGSPLITTERS

Product Description & Intended Purpose:

This Log Splitter / Wood Splitter is an outdoor product that splits wood logs for use as fuel in a fireplace or a woodstove.



WARNING: All operators must read this manual, before operating this RedGum Splitter.

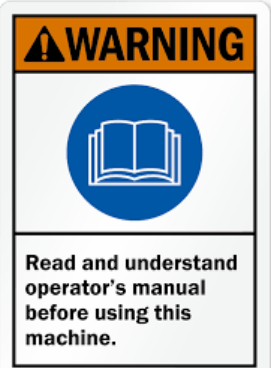



Table of Contents



IMPORTANT SAFETY RULES	3
WARNING LABELS & DEFINITIONS	4-5
GENERAL SAFETY PRACTICES	6-7
LOG SPLITTER & ENGINE COMPONENTS	8-9
OPERATION INSTRUCTIONS	10-11
TOWING YOUR LOG SPLITTER	12
MAINTAINING YOUR LOGSPLITTER	13-14
TROUBLESHOOTING	15
WARRANTY & SERVICE INFORMATION	16-18

IMPORTANT SAFETY RULES



	<p>WARNING Improper, unsafe, or reckless use of this machine could result in severe personal injury to the operator and bystanders.</p> <p>This machine operates with high pressures and natural occurring wood has inherent variable characteristics that may result in changing outcomes.</p>
	<p>Read this manual completely.</p> <ul style="list-style-type: none"> - Serious injury or death can result if safety instructions are not followed. - Everyone who operates this log splitter must read and completely understand all safety rules, operating instructions, and maintenance instructions. - You must be 18 or older to operate this machine and in sound mind, free of the influence of medication, drugs, or alcohol. Keep untrained people away.
1	This is a one-person machine. Never allow bystanders to interfere with the operation and keep an exclusion zone of 3.0m around the machine while in operation
2	Read the owner manual thoroughly and fully understand the machines operation. Any questions or clarification must be directed to your supplier
3	Do not make any modifications to the machine. If the machine has been found to be modified or tampered with in any way STOP. Have the machine inspected by authorised person (eg. Dealer, supplier, or qualified person)
4	Do not operate this machine if you are affected by alcohol, drugs or fatigued.
5	Always wear the appropriate Personal Protective Equipment that includes but not limited to, Safety boots, Safety glasses, Suitable gloves, Hearing protection and appropriate clothing.
6	Check machine before operation for loose bolts, fittings and worn parts. Rectify before operation commences.
7	Check fuel and oil levels
8	When towing the machine, keep below 30kph. Drive to conditions and avoid holes and rocks that may cause the machine to tip. Not for Highway use.
9	Operate the machine on level ground with a suitable cleared area to avoid congestion and tripping hazards
10	Do not exceed the lifting capacity of the machine
11	Ensure the block is sitting firmly on the table prior to splitting.
12	Read and follow the risk assessment at the end of this manual.

WARNING LABELS & DEFINITIONS

	WARNING!
 <p>WARNING</p> <p>Read and understand operator's manual before using this machine.</p>	<p>WARNING Read and thoroughly understand all instructions contained in this operation manual before operating this RedGum Splitter. Serious injury or death can result if safety instructions are not understood or followed. If you wish to discuss this log splitter's operational procedures after reading this manual, please call our Customer Service on 1300 039 251, available Monday to Friday, from 9AM to 5PM AEDT.</p> <p>You must be 18 or older to operate this machine and in sound mind, free of the influence of medication, drugs, or alcohol.</p> <p>Keep untrained people away.</p>
	<p>Crush hazard. The Crush Hazard Zone is between the Splitting Wedge and the Splitting Bed. The Splitting Wedge can cut through skin and break bones. Make sure hands are clear of crush hazard zone when log splitter is in operation.</p>
	<p>Flying objects. - Pieces of wood may fly out while splitting. Wear safety glasses. Serious eye injury can occur if safety glasses are not worn. - Serious accidents can happen when other people are allowed inside the safety and operator zone. Keep everyone else out of the safety and operator zone while operating log splitter. See page 5 for operator zone</p>
 <p>WARNING</p> <p>Skin Puncture Hydraulic Line</p>	<p>Skin injection hazard. - High pressure fluid can inject under skin resulting in serious injury including amputation. - If skin injection happens, seek immediate "Surgical Treatment". Call 000 - Make sure all fittings are tight before starting the log splitter. Relieve system pressure before servicing by turning off the log splitter and moving Control Valve Lever back to the neutral position. - Do not check for leaks with hand. Investigate and repair any hydraulic leaks immediately</p>
 <p>RISK OF FIRE</p>	<p>Risk of fire and explosion.</p> <p>Hot exhaust fumes from the engine can cause a fire. Gasoline is highly flammable and explosive. You can be burned or seriously injured when handling fuel. Position muffler at least 7 feet from combustible objects.</p>

	<p>Before adding fuel, stop the engine and keep heat, sparks, and flame away. Do not add fuel when engine is running or still hot. No smoking near engine. Do not pump fuel directly into engine at gas station. Static charge can build and ignite fuel. Use an approved fuel container to transfer petrol to the engine. Wipe up fuel spills immediately. Turn Fuel tap off in storing and transporting machine. Store and handle fuel outdoors. Gasoline vapours can ignite if they collect inside an enclosure.</p>
	<p>Poisonous fumes from the engine can kill you. Do not operate indoors even if ventilated. This product is intended for outdoor use only.</p>
	<p>Hot muffler. You can be burned by the muffler. Do not touch muffler during or immediately after use.</p>

Hazard Signals Definitions

	<p>This is the safety alert symbol. It is used to alert you to potential personal injury hazards. Obey all safety messages that follow this symbol to avoid possible injury or death</p>
	<p>DANGER indicates an imminently hazardous situation which, if not avoided, will result in serious injury or death.</p>
	<p>WARNING indicates a potentially hazardous situation which, if not avoided, will result in serious injury or death</p>
	<p>CAUTION indicates a potentially hazardous situation which, if not avoided, could result in minor or moderate injury</p>

GENERAL SAFETY PRACTICES

- Read, understand, and follow all instructions on the machine and in the manual(s) before attempting.
- Be familiar with all controls and proper operation. Know how to stop the machine and disengage them quickly.
- Never allow children under 16 to operate this machine. People over 16 should read and understand the instructions and safety procedures and be trained by a competent person.
- No one should operate this machine without proper instruction.
- Accidents are more likely to occur when more than one person operates the machine. If a helper is loading logs, make sure he/she is well clear (3m) before activating the splitter.
- Keep bystanders, children, pets, and helpers 6m from the machine while in operation.
- Never allow anyone to ride on the machine.
- Hydraulic log splitters generate high oil pressures and escaping fluid under pressure through a pin hole or break in the hoses can penetrate the skin and cause serious injury. Always give attention to the following instructions.
- Never check for hydraulic leaks with your hands
- Do not operate the machine with frayed or kinked hoses, cracked or damaged hoses.
- Before replacing hoses and making adjustments, STOP the engine and release the hydraulic pressure in the system.
- DO NOT adjust the hydraulic pressure setting in the pump or the valve.
- Check for leaks with protective gloves and glasses and use cardboard or wood by passing it over the hoses suspected leak areas.
- If injured by high pressure escaping fluid, see your doctor immediately. Delays may worsen the situation.
- Keep the operating area clear and free of trip hazards.
- The machine is fitted with an internal combustion engine that has the potential to start fires. Keep the engine clean and free of dust and debris and ensure the spark arrestor is in good working order. Comply with all local laws in relation to safety and fire prevention. Have appropriate firefighting equipment with you.
- This machine should be used for splitting wood only and not for any other purpose.
- Always wear safety boots when using this machine
- Always wear safety glasses when using this machine
- Never wear jewelry or loose clothing or long hair that may become entangled in the moving parts of this machine.
- Make sure the machine is setup on a level surface.
- Make sure the machine is not moving during operation.
- Always operate the machine from the designated operator zones.
- Logs should be cut with square ends perpendicular to the grain prior to being split.
- Always use the splitter in daylight hours or use good lighting.
- To avoid personal injury and damage, take extreme care when handling petrol. This is extremely flammable, and vapors are potentially explosive. Avoid any ignition source or naked flame while handling fuel and any spills must be cleaned up immediately. In the event of spills on clothing or skin, clean up immediately.
- Use only an approved fuel container.
- Extinguish flames, pilot light cigarettes and all other sources of ignition before fueling takes place.
- Never fuel the machine indoors
- Never remove the petrol cap while the engine is running.

- Never over fill the fuel tank. Leave 1 – 2 cm below the base of the filler neck. This allows for expansion in hotter weather.
- Ensure fuel cap is replaced securely.
- If there is a fuel spillage, clean off the engine and move to a new location before starting.
- Never store the machine for fuel containers inside where they are maybe a naked flame such as a water heater, boiler, open fire or other sources of naked flames.

YOUR RESPONSIBILITY

Restrict the use of this powerful machine to persons who read understand, and follow the warnings and instructions in this manual and on the machine. Always follow directions on the safety labels found on your equipment.

WORK AREA FOR THE LOG SPLITTER

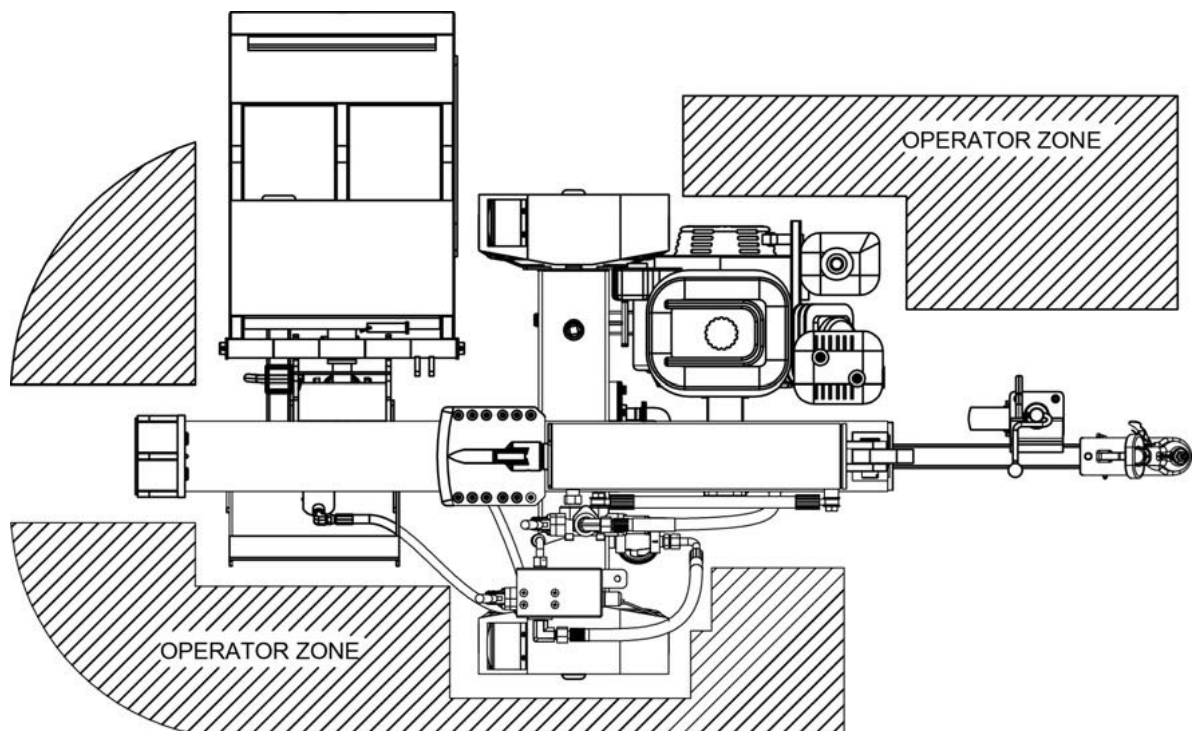

NOTE: Serious accidents can happen when non-operators are allowed inside the work zone. Keep everyone else outside the work zone while operating the control lever. Make sure to use appropriate PPE gear while operating the log splitter within the work zone.

LOG SPLITTER COMPONENTS

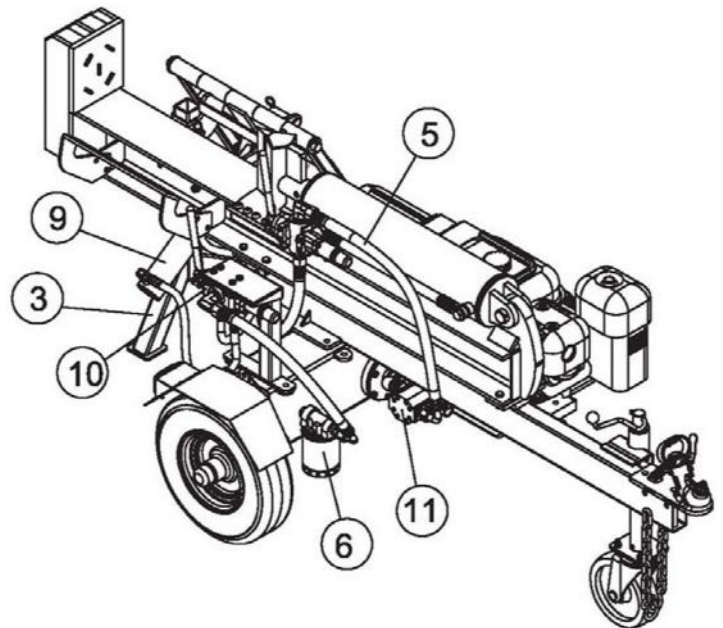
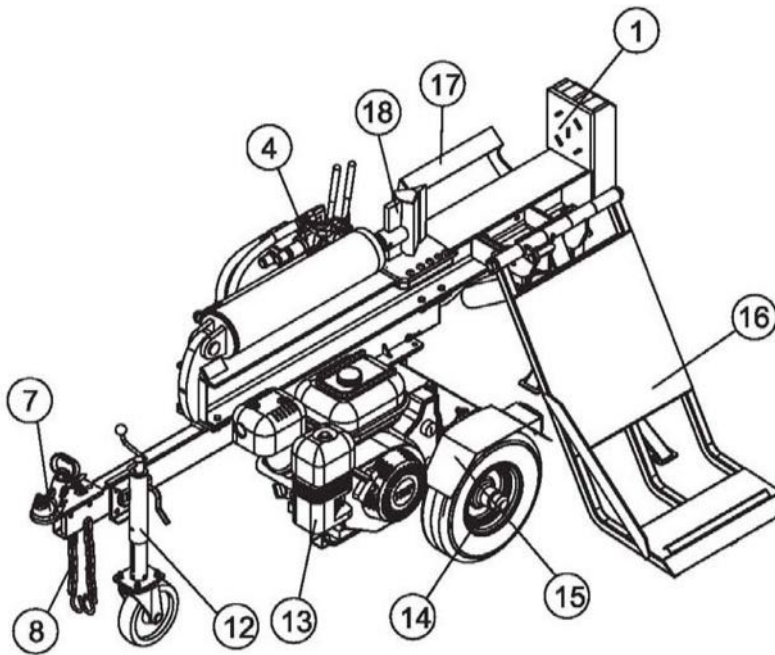

- 1) **End Plate** – 106mm thickness
- 2) **Beam** - 6" extra wide flange.
- 3) **Rear Support Leg** – The leg supports the log splitter steadily while operating
- 4) **Control Valve** – Controls the forward and backward movement of splitting wedge
- 5) **Hydraulic Cylinder**- 5" bore and 19.4"stroke.
- 6) **External Filter** – Filters the hydraulic oil.
- 7) **50MM Coupler** – Attaches the log splitter to 50mm hitch ball
- 8) **Safety Chains** – Safety feature to prevent loss of log splitter while towing.
- 9) **Hydraulic Table Lift Ram** – to lifting and lowering the hydraulic table
- 10) **Hydraulic Table Control**
- 11) **Gear Pump** – Pumps the hydraulic oil through the system.
- 12) **Jockey Wheel**
- 13) **Engine** – 15HP manual start petrol engine
- 14) **Tires** – Maximum rated towing speed is 35km/h.
- 15) **Fender**
- 16) **Lifting Table** – used for lifting the logs
- 17) **Log Cradle**- Keeps the log on the beam without operator assistance.
- 18) **8" Wedge** – Features wedge wings and tapered ends making splitting

LOG SPLITTER SPECIFICATIONS

Cycle Time	18 Secs
Hydraulic Tank Capacity	4.3 Gallons (16 liters)
Max. Log Length	21.6 inches (55cm)
Coupler Ball Size	50mm
Tire Size	16 inches
Max. Towing speed	35 km/h
Engine	Honda GX390 OHV 4-Stroke
Cylinder size	5inch x 19.4 Inch (127 x 493mm)
Gear Pump	2 Stage, 16GPM (57.5 L/min)
Max Pressure	3600psi (25Mpa)
Control Valve	Detent Auto Return
Dimensions H x W x L	215.3 x 111.7 x 90.5cm

Hydraulic Oil

Oil Capacity is 3.4 gallons (12.8L). Only use AW46 or ISO46 Hydraulic Oil.

ENGINE COMPONENTS

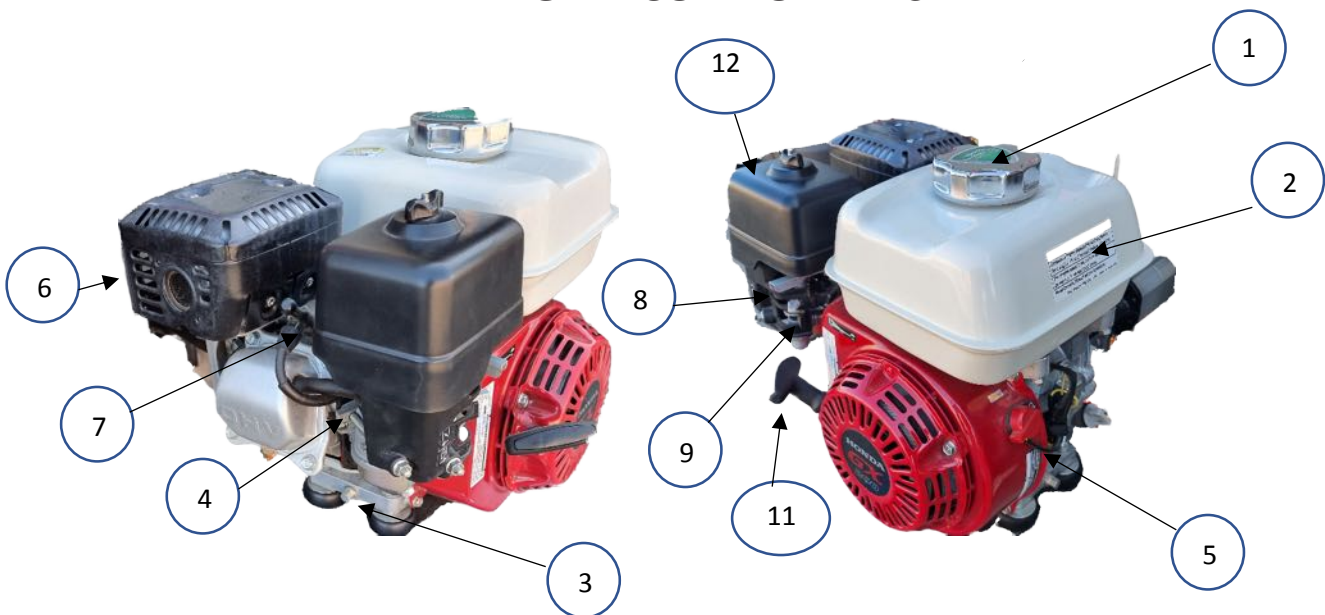

1. Fuel Cap
2. Fuel Tanks
3. Oil Drain Plug
4. Oil Filler Cap
5. On/Off Switch
6. Muffler

7. Spark Plug
8. Choke Lever
9. Fuel Valve
10. Starter Grip
11. Recoil Starter
12. Air Cleaner

OPERATING YOUR LOGSPLITTER

Control Handle

The Control handle has 3 positions (See diagram)

1. Forward or down: This moves the axe head forward to split wood. Note that the handle will automatically move to neutral as soon as the handle is released.
2. Neutral: Move to this position will stop the movement of the axe head.
3. Reverse: Move the handle to the backward position and the axe head will return to the top of the stroke. The handle will AUTOMATICALLY return to NEUTRAL at the end of the stroke.

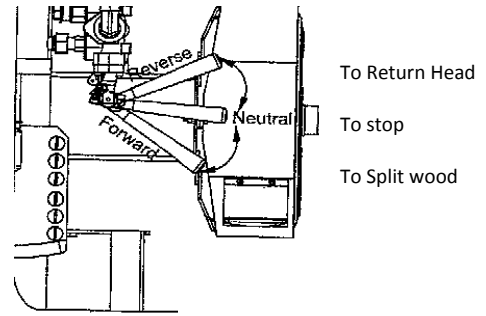

WARNING!

Wear appropriate PPE when operating this machine. Work gloves, Safety boots, protective glasses, hearing protection and appropriate clothing.

A working engine and one that has recently been turn off will be hot and avoid touching the engine and exhaust as they will burn and ignite flammable material if placed in contact with these areas. Dry grass, wood, bark, and other flammable materials. Do NOT Overfill the engine with oil. Always check oil levels before use.

Starting the Engine

1. Attach spark plug wire to spark plug. Make certain the metal cap on the end of the spark plug wire is fastened securely over metal tip of the spark plug.
2. Turn fuel valve, if equipped, to the ON position.
3. Move choke lever, if equipped, to CHOKE position if engine is cold.
4. Advance the Throttle to 25%
5. Pull the starter handle firmly until the engine starts.
6. Allow the starter handle to retract in a controlled manner. Never let it fly back on its own.
7. Move the choke leaver to the off position.
8. Advance the throttle to working revs which is around 80%
9. Cycle the axe head several times particularly on cold days. This will warm the oil and eliminate any air in the system.

Stopping the Engine

1. Move throttle to idle position.
2. Turn the engine switch to OFF.
3. Secure as required.

Operating the Log Splitter

1. Start the engine and make sure the log splitter is on level ground before operating.
2. Put both the support legs in the down position to prevent the log splitter from moving during operation and make sure that both the tires are blocked from any movement.
3. Load a log on the beam against the endplate, as per the image below.

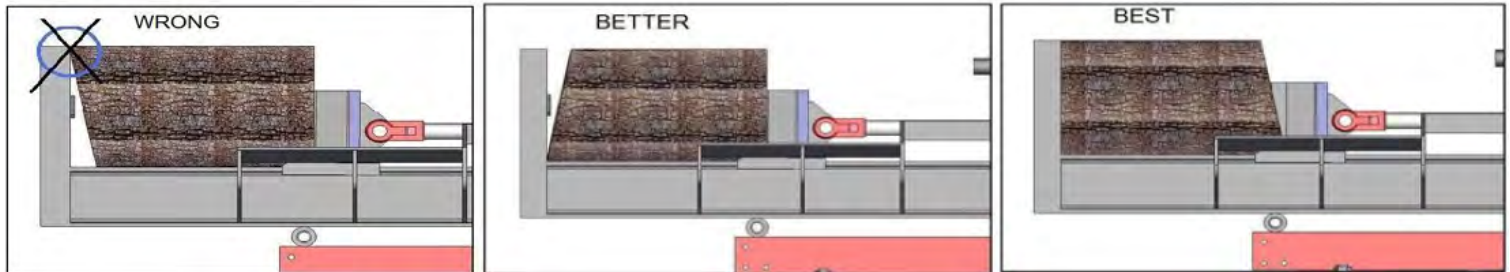

4. Push the control lever FORWARD by one hand to split the log.
5. Push the control lever BACKWARD by one hand to return wedge to its original position.

WARNING!

Wedge can cut through skin and break bones. Keep both hands away from wedge and beam slide. Serious accidents can happen when other people are allowed inside the work zone. Keep everyone else out of the work zone while operating control lever.

DO NOT wear loose clothing. It can get tangled in moving parts of log splitter. Only use the log splitter in daylight so you can see what you are doing.

If a log gets stuck, embedded or will not split completely, push the control lever in the reverse direction and allow the splitter to strip the log from the wedge.

If the log still remains stuck, embedded or will not split, turn the machine off and use a sledge hammer and crow bar to remove the log.

ALWAYS keep hands clear of the log and wedge while it is retracting.

Never remove partially split wood from the axe head as it may be under tension and could trap your hands and fingers. This is common for wood that is not completely dry.

Note: Make sure hands are clear from the wedge and crush hazard areas.

TOWING YOUR LOG SPLITTER

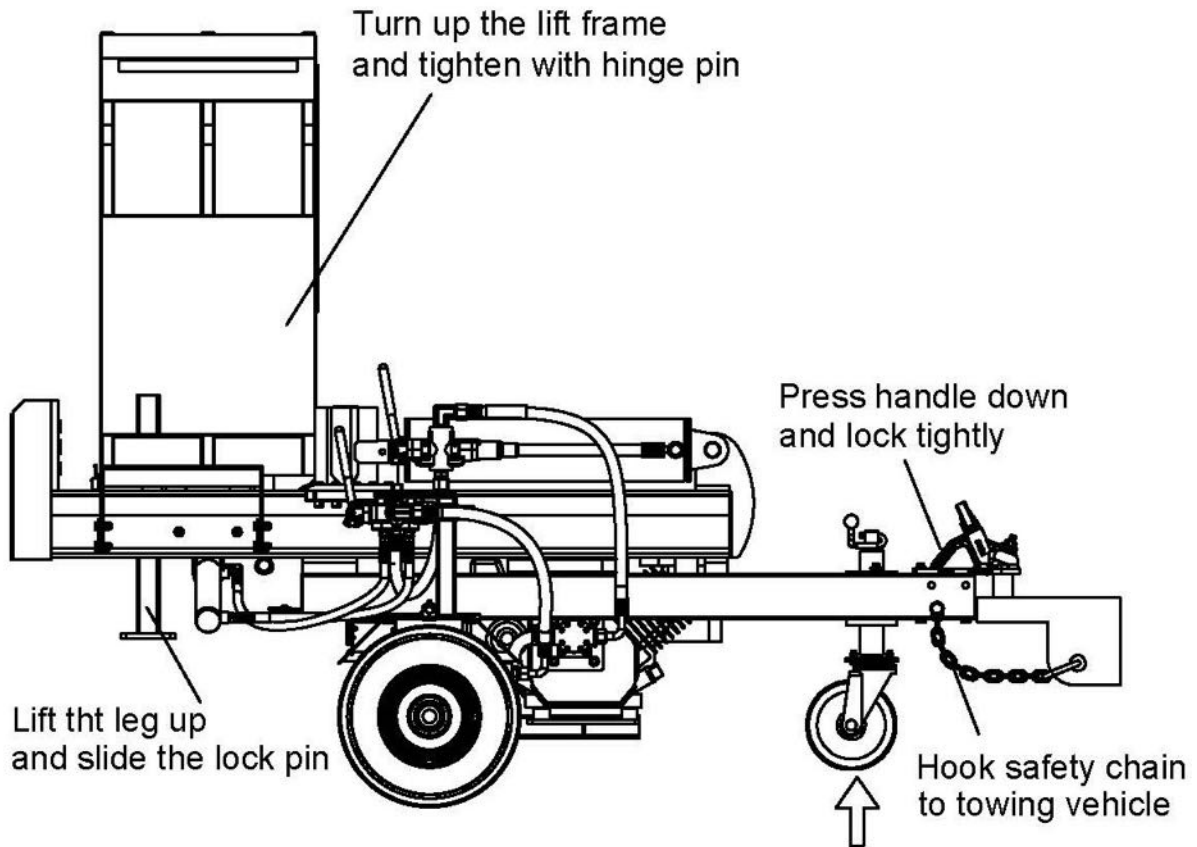

1. **IMPORTANT:** Always turn fuel valve to OFF position before transporting the log splitter.
2. Make certain the beam is locked securely with the horizontal beam lock pin.
3. Lift up the Rear Support Leg up and secure it in place with the lock pin.
4. Swing and lift up the Lifting Table as per the picture above. Secure it in place using the hinge pin.
5. Swing down the Jockey Wheel and make sure that it is secured with the lock pin.
6. Attach the coupler hitch to a class I or higher ball on a towing vehicle. Latch securely with with support chains.
7. Press down the lock handle tightly and make sure that it is secured in place.

 **WARNING!**

This log splitter is NOT ROAD-TOWABLE. It can only be towed around the property at a max rated speed of 35 km/h.

MAINTAINING YOUR LOG SPLITTER

Hydraulic Oil and Filter

Check the hydraulic fluid level in the tank before each use. Maintain the level within the range always shown by the dip stick.

Change the fluid and filter after every 100 hours of use, as follows:

1. To discharge the old oil, remove the drain plug and disconnect the suction hose.
2. Remove the inlet flange and carefully unscrew the oil filter. The filter is reusable and can be cleaned with a suitable cleaning fluid. If the filter is damaged in any way, it must be replaced with a new one from your dealer.
3. Allow all waste oil to drain into a suitable container.
4. Follow the step-in reverse to replace the filter and the drain plug.
5. Contaminants in fluid may damage the hydraulic components. Flushing the reservoir tank and hoses with kerosene whenever service is performed on the tank, hydraulic pump or valve is recommended. Contact an authorized seller/dealer.
6. Only use AW46 or ISO46 Hydraulic Oil.
7. It is recommended the filter.

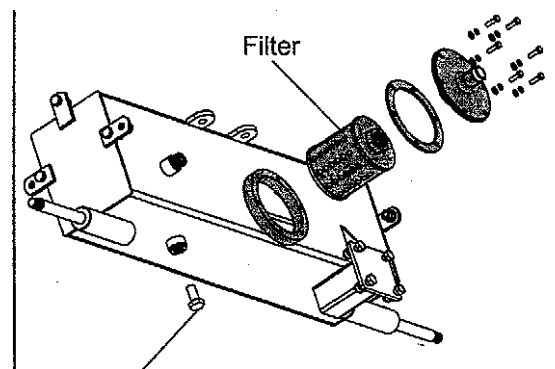

Note: Always dispose of waste oil and filter at approved recycling centers only.

Beam and Splitting Wedge

Lubricate both sides of the beam (where it meets the splitting wedge), before each use, with engine oil. The wedge plate on the log splitter is designed so the gibs on the side of the wedge plate can be removed and rotated and/or turned over for even wear.

Make certain to readjust the adjustment bolts so wedge moves freely, but no excess space exists between the wedge plate and the beam.

Hose Clamps

Check, before each use, if hose clamps on the suction hose (attached to the side of the pump) - check the hose clamps on the return hose at least once a season.

Honda Engine

Refer to the separate Honda engine manual for all maintenance instructions.

Tires

See sidewall of tire for recommended pressure. Under any circumstances do not exceed manufacturer's recommended psi. Maintain equal pressure on all tires.

Storing Your Log Splitter

Prepare your log splitter for storage at the end of the season or if the log splitter will not be used for 30 days or more.

WARNING: Never store machines with fuel in the fuel tank inside of building where fumes may reach an open flame or spark, or where ignition sources are present such as hot water and space heaters, furnaces, clothes dryers, stoves, electric motors, etc.

Cleaning the log splitter

NOTE: We do not recommend the use of pressure washers or garden hose to clean your unit. They may cause damage to bearings or the engine. The use of water will result in shortened life and reduced serviceability.

1. Wipe the unit with an oiled rag to prevent rust, especially on the wedge and the beam.
2. Drain fuel tank. Always drain fuel into approved container outdoors, away from open flame. Be sure that the engine is cool before draining the fuel. Do not smoke while handling fuel.
3. Remove spark plug. Holding a rag over the cylinder hole, pour approximately 1/2 ounce (approximately one tablespoon) of engine oil into cylinder and crank slowly to distribute the oil.
4. Replace spark plug.
5. Do not store fuel from one season to another. Use of a fuel preservative is recommended. See your dealer for details.
6. Replace your gasoline can if it starts to rust. Rust and/or dirt in the gasoline will cause problems.
7. Store unit in a clean, dry area. Do not store next to corrosive materials, such as fertilizer.

NOTE: If storing in an unventilated or metal storage shed, be certain to rustproof the equipment by coating it with a light oil or silicone.

TROUBLESHOOTING

Problem	
Cylinder rod will not move	SOLUTION: A,D,E,H,J
Slow cylinder rod speed when extending or retracting	SOLUTION: A,B,C,H,I,K,L
Wood will not split or splits extremely slowly	SOLUTION: A,B,C,F,I,K
Engine bogs down during splitting	SOLUTION: G,L
Engine stalls under low load condition	SOLUTION: D,E,L,M
Cause	Solution
A -Insufficient oil to pump	Check oil level in reservoir
B -Air in oil	Check oil level in reservoir
C -Excessive pump inlet vacuum	Check pump inlet hose for blockage or kinks
D -Blocked hydraulic lines	Flush and clean the splitter hydraulic system
E -Blocked control valve	Flush and clean the splitter hydraulic system
F -Low control valve setting	Adjust control valve with a pressure gauge
G -High control valve setting	Adjust control valve with a pressure gauge
H -Damaged control valve	Return control valve for authorized repair
I -Internal control valve leak	Return control valve for authorized repair
J -Internal cylinder leak	Return cylinder for authorized repair
K -Internally damaged cylinder	Return cylinder for authorized repair
L -Engine Control out of adjustment	Adjust idle control nuts
M -Engine is loaded during idle down mode	Use shorter log length (21.65" or less) to allow engine to speed up before contact.

WARRANTY AND SERVICE INFORMATION

Congratulations on the purchase of your new RedGum product. RedGum Products will assist you to complete the “job at hand” in an economical, safe and efficient manner.

This brochure explains the Warranty and Maintenance information for your product. This combined with your Owner’s Manual and the knowledge and expertise offered to you by your respective RedGum Dealer should provide you with confidence that your decision to purchase a RedGum product was a good one.

STATEMENT OF WARRANTY

This statement of warranty applies to all RedGum products (offered by the manufacturer, RedGum Products). The manufacturer provides this warranty to the initial purchaser of this product (who has purchased it from an authorized RedGum Products dealer) for a period commencing from the date of purchase.

If the product is found to be defective, in RedGum Products' opinion (due to a fault of the manufacturer) within the Warranty Period, RedGum Products will carry out the repair or replacement to the customer Free of Charge, provided:

- The fault is reported directly to the place of purchase.
- Sufficient proof of purchase is provided.
- The fault is not caused by misuse, neglect, or incorrect adjustment by the user.
- The failure has not occurred through normal wear and tear.
- The product has not been serviced, repaired or edited by anyone not authorised by RedGum Products.

THE WARRANTY PERIODS

NOTE

Engines are covered by the respective original equipment manufacturers warranty and claims are made direct to the manufacturer agent Replacement parts and accessories fitted during a repair under terms of warranty will enjoy cover for the remainder of the warranty period of the finished product

Your RedGum Splitter has the following warranty periods, which starts on the date of purchase:

Private Domestic Use	24 Months
Commercial Use	3 Months

Please note that Warranty Claims for a RedGum product can only be made through an Authorized RedGum Dealer

WHAT IS NOT COVERED BY WARRANTY

The following items are not covered by this warranty:

- Normal maintenance items which become worn through use, including, but not limited to, belts, blades, oil, blade adapters, filters, rewind springs, spark plugs, starter ropes, clutches, and sprockets.
- Natural discoloration of material due to sunlight.
- Engines not manufactured by RedGum Products, these items are covered by the respective original equipment manufacturers' warranty, all claims must be sent to the appropriate manufacturer's agents.
- Using stale or contaminated fuel in the product.
- Damage or failure caused by accident, misuse and/or neglect, including, ingress of dirt, abrasives, moisture, rust & corrosion, and damage due because of inadequate maintenance.
- Failure to operate or maintain the unit in accordance with the Owners/Operators manual, this handbook or instruction given by a RedGum dealer.
- Alterations or modifications that change the intended use of the product or affect the product's performance, operation, safety or durability, or causes the product to fail to comply with any applicable laws.
- Damage due to incorrect usage such as incorrect log placement (as shown in the product's respective Owner's Manual)
- Additional damage to parts or components due to continued use occurring after any of the above.

ITEMS FOR WHICH A CHARGE WILL BE MADE:

The following list is a guide to the types of items for which a charge will be made (unless failure is caused by a defect in the manufacturer's materials or workmanship).

Service: Maintenance servicing and all parts and fluid replaced in line with the maintenance schedule shown in this handbook.

Mechanical Adjustments: Including engine tuning, adjusting brakes, belts & clutches etc.

Drive System: Sprockets, belts, clutches, pulleys, and bearings all wear and will require replacement.

Cutting Equipment: Blades, cutting discs and hammers wear during use and sharpening/replacement is required as a matter of normal maintenance.

Spark Plugs: Periodic replacement is required to ensure maximum engine performance and best fuel economy.

Induction/Combustion System: The removal of deposits and cleaning may be required from time to time and should be performed as necessary.

Tyres: Tyres are subject to wear and if they come in contact with external objects, they can deflate. A flat tyre is not a warrantable item.

External Surfaces, Paint, Trim and other Appearance items: Are affected by normal wear and tear and exposure to environmental conditions. A charge will be made for paint and trim items that require attention due to causes outside the manufacturer's control.

Hydraulics: Changing hydraulic fluids the frequency of replacement, repair or adjustment will depend mainly on where and how you use your product, weather, atmospheric and environmental conditions, and frequency of use.

CUSTOMER RESPONSIBILITIES

The customer must provide to an authorised RedGum Dealer their proof of purchase information such as a receipt.

The product must exhibit reasonable care in the maintenance, operation, storage, and general upkeep practices as explained in the maintenance section of the Owners/Operators Manual or this handbook. This includes the whole product or any general wear item or component on the product. Any costs incurred to obtain warranty consideration or services is the customer's responsibility, including shipping and handling, travel expenses, lost time, lost production or pickup and delivery.

YOUR RIGHTS AS A CUSTOMER

The New Product Warranty that is provided by RedGum Products is in addition to the rights and remedies conferred on consumers by the relevant authorities and/or legislation. The warranty does not affect those rights or remedies, except to the extent that their application may lawfully be excluded. Any consequential, direct, or incidental loss or damage is not covered by the warranty.

Any statutory or other rights or remedies available in connection with a claim for such loss or damage should be pursued separately.

WHERE TO GO FOR WARRANTY & REPAIRS

Take your product to any authorised RedGum Dealer if it needs warranty repairs. All authorised RedGum Dealers will honour the New Product Warranty, and will repair, replace, or adjust free of charge any part of your product that is defective in factory materials or workmanship. Please note that RedGum is unable to re-imburse the cost of repairs carried out during the warranty period by a repairer who is not an Authorised Servicing Dealer.

WARRANTY INFORMATION



Please note down for future reference:

Machine: RedGum MAX 390+ Lifter-Splitter (Honda GX390)

Customer Name:..... **Phone No.:**.....

Address:.....

Date of Purchase:.....

Serial Number:.....

Engine Number:.....

Dealer Name:.....

To find your nearest Authorised RedGum Products dealer,

Visit www.RedGumProducts.com.au or Call Toll-free 1300 039 251

The manufacturer reserves the right to make improvements in design and/or changes in specifications at any time without incurring any obligation to install them on units previously sold.

NOTES

.....

.....

.....

.....

ACCESSORIES AVAILABLE

1.) RedGum Hydraulic Oil (Fluid 46 5L) - RRP \$49.75

High quality hydraulic oil fluid - ideal for topping up your RedGum logsplitter's hydraulic reserve, when required.



2.) RedGum Logsplitter Dust Cover - RRP \$99

Heavy-duty 200D logsplitter cover for superior protection against dust, dirt and heavy rain!



3.) Dual Purpose Log Lifter & Roller - RRP \$189

This dual purpose log lifter & roller allows you to effortlessly roll large logs and keep them off the mud! Sturdy dual-foot design prevents the handle from digging into the ground.



4.) Tazzy Devil Log Roller/Lifter - RRP \$269

This amazing tool with a wide footprint not only rolls logs over but also lifts the log off the ground allowing complete pass through cuts without touching the ground & dulling your chain.



REDGUM
products

POWERED by
HONDA™

For more information contact your local RedGum Dealer

Visit: www.RedGumProducts.com.au

Phone: 1300 039 251



Follow us on Facebook: www.facebook.com/redgumproducts